

Table of Contents

Laminate Tabletops.....	3
Bamboo Tabletops.....	5
Bamboo Ergo Cut Tabletops.....	6
Solid Wood Tabletops.....	8
Epoxy Tabletops.....	9
Seamless Particle Board Tabletops.....	11
Care & Maintenance.....	13
Tabletop Dimensional Drawings.....	14
Warranty & Contact Information.....	20



Have any queries? Our expert engineers are here to help!



sales@progressivedesk.com



1-800-828-9414



progressivedesk.com

Laminate Tabletops

Our laminate tabletops have an MDF core which does not shrink or swell from temperature and humidity, and are also resistant to changes in color due to UV light. Available in a large variety of different sizes ranging from 30" × 30" all the way up to 72" × 30" and an ever-expanding choice of colors, you can pick the perfect laminate tabletop for your office!

Sealed with a layer of laminate, each laminate tabletop requires little to no maintenance and is practically immune to environmental factors that may otherwise cause cracking, splitting, or warping. We back our laminate tabletops with a 15-year warranty to guarantee style, quality, and durability that will serve you well over the years!

THICKNESS

All options have a 1.00" thickness.

SIZES & COMPATIBILITY

Available Sizes	Compatibility
30" × 30"	Mini Ryzer, Corner Ryzer (Secondary Frame)
42" × 24"	Economy Ryzer, Prime Ryzer, Corner Ryzer (Secondary Frame)
48" × 30"	Economy Ryzer, Prime Ryzer, Solo Ryzer, Corner Ryzer
55" × 28"	Economy Ryzer, Prime Ryzer, Solo Ryzer, Corner Ryzer
60" × 30"	Economy Ryzer, Prime Ryzer, Solo Ryzer, Corner Ryzer
72" × 30"	Solo Ryzer, Corner Ryzer (Primary Frame)

MATERIAL

Surface Material	Bottom Material	Edge Material	Core Material
Laminate	Laminate	PVC	MDF

COMPARISON TABLE

SKU	DT-3030	DT-4224	DT-4830	DT-5528	DT-6030	DT-7230
Grommet Style	No Grommet	No Grommet	Circular	Dual Circular	Rectangular	Dual Circular
Grommet Size	No Grommet	No Grommet	3.2" Diameter	3.2" Diameter	11.6" × 4.4"	3.2" Diameter
Includes	5x Machine Screws, 5x Washers, 8x Countersunk Screws (2 Lengths), 2x Hex Keys (2 Sizes)	8x Machine Screws, 8x Washers, 1x Hex Key	8x Machine Screws, 8x Washers, 1x Hex Key	8x Machine Screws, 8x Washers, 1x Hex Key	8x Machine Screws, 8x Washers, 1x Hex Key	8x Machine Screws, 8x Washers, 1x Hex Key
Dimensions (L×W×H)	30.0" × 30.0" × 1.0"	42.0" × 23.6" × 1.0"	47.6" × 30.0" × 1.0"	55.0" × 27.5" × 1.0"	60.0" × 30.0" × 1.0"	72.0" × 30.0" × 1.0"

AVAILABLE COLORS

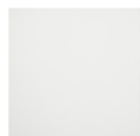

Warm
White

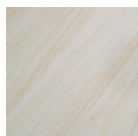

Bright
Beech

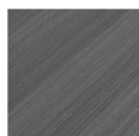

Gray
Oak

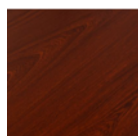

Dark
Cherry

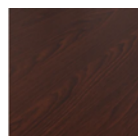

Roasted
Walnut



Ebony
Oak

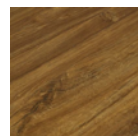

Rustic
Hickory

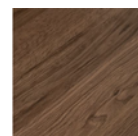

Light
Walnut

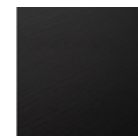

Pure
Black

Available in 48" × 30" and 60" × 30" only

Laminate Tabletops

30" × 30"

Mini Ryzer - Gray Oak



48" × 30"

Economy Ryzer - Dark Cherry



55" × 28"

Prime Ryzer - Warm White



55" × 28"

Solo Ryzer - Warm White



78" × 60"

Corner Ryzer - Ebony Oak



78" × 72"

Corner Ryzer - Dark Cherry



Bamboo Tabletops

As the fastest-growing plant on Earth, bamboo is excellent material for sustainability and reducing our environmental footprint. Our bamboo tabletops perfectly combine style and functionality with eco-friendliness. We offer either a light matte or a dark gloss color for these tops which come in a variety of different sizes ranging from 48" × 30" all the way up to 72" × 30"!

The sleekness and quality of these tops make them perfect for any home or office setting. Features such as their scratch and water resistance, ensure it's protected during day-to-day usage. Being completely comprised of carbonized bamboo, they are high-quality and durable so you can have peace of mind knowing your tabletop is sustainable and made to last with a 15-year warranty.

THICKNESS

All options have a 1.00" thickness

INCLUDED HARDWARE

Hardware	Qty
M6×18 Machine Screws	8
Hex Key	1

SIZES & COMPATIBILITY

Available Sizes	Compatibility
42" × 30"	Economy Ryzer, Prime Ryzer, Solo Ryzer
48" × 30"	Economy Ryzer, Prime Ryzer, Solo Ryzer
60" × 30"	Economy Ryzer, Prime Ryzer, Solo Ryzer
72" × 30"	Solo Ryzer

MATERIAL

Surface Material	Bottom Material	Edge Material	Core Material
Natural Bamboo	Natural Bamboo	Natural Bamboo	Natural Bamboo

AVAILABLE COLORS

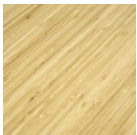

Bamboo
Light Matte

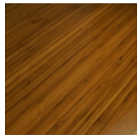

Bamboo
Dark Gloss

Bamboo Ergo Cut Tabletops

We made these bamboo tabletops with the environment in mind! They don't just look lovely with their smooth, rounded design, but they're also good for the planet, making them a smart choice for people who care about nature. The "Ergo Cut" design on the bamboo desktops helps your wrists and arms be in a comfy position, so you won't feel tired. It makes working easier and more pleasant. This ergonomic design is all about fitting well into your space and giving you the best comfort possible.

THICKNESS

All options have a 1.00" thickness

SIZES & COMPATIBILITY

Available Sizes	Compatibility
48" × 30"	Economy Ryzer, Prime Ryzer, Solo Ryzer
55" × 28"	Economy Ryzer, Prime Ryzer, Solo Ryzer
60" × 30"	Economy Ryzer, Prime Ryzer, Solo Ryzer
72" × 30"	Solo Ryzer

COMPARISON TABLE

SKU	DT-4830	DT-5528	DT-6030	DT-7230
Grommet Style	Single Circular Grommet	Dual Circular Grommets	Dual Circular Grommets	Dual Circular Grommets
Grommet Size	3.2" Diameter	3.2" Diameter	3.2" Diameter	3.2" Diameter
Includes	8x Machine Screws, 8x Washers, 1x Hex Key	8x Machine Screws, 8x Washers, 1x Hex Key	8x Machine Screws, 8x Washers, 1x Hex Key	8x Machine Screws, 8x Washers, 1x Hex Key
Dimensions (L×W×H)	47.6" × 30" × 1.0"	55.0" × 27.5" × 1.0"	60.0" × 30.0" × 1.0"	72.0" × 30.0" × 1.0"

MATERIAL

Surface Material	Bottom Material	Edge Material	Core Material
Natural Bamboo	Natural Bamboo	Natural Bamboo	Natural Bamboo

AVAILABLE COLORS



Light
Bamboo



Black
Bamboo

Bamboo Tabletops

60" x 30"

Solo Ryzer - Bamboo Light Matte



72" x 30"

Solo Ryzer - Bamboo Dark Gloss



60" x 30"

Solo Ryzer - Bamboo Light Matte



72" x 30"

Solo Ryzer - Bamboo Dark Gloss



60" x 30"

Solo Ryzer - Light Bamboo



48" x 30"

Solo Ryzer - Black Bamboo



Solid Wood Tabletops

Solid wood tabletops embody the perfect mix of form and function. Crafted from high-quality solid wood, these tabletops have natural warmth and beauty and promise lasting durability. Each tabletop's unique grain patterns and color variations provide a visually appealing background to your daily activities. With options in two sizes, you can choose the perfect fit for your workspace. Beyond aesthetics, these tabletops are sturdy and stable. They are easy to maintain and can withstand the test of time, making them a practical and eco-friendly choice.

THICKNESS

All options have a 1.00" thickness

SIZES & COMPATIBILITY

Available Sizes	Compatibility
60" × 30"	Solo Ryzer
72" × 30"	Solo Ryzer

COMPARISON TABLE

SKU	DT-6030	DT-7230
Grommet Style	Dual Circular Grommets	Dual Circular Grommets
Grommet Size	3.2" Diameter	3.2" Diameter
Includes	8x Machine Screws, 8x Washers, 1x Hex Key	8x Machine Screws, 8x Washers, 1x Hex Key
Dimensions (L×W×H)	60.0" × 30.0" × 1.0"	72.0" × 30.0" × 1.0"

MATERIAL

Tabletop Material	Finishing
Solid Wood	UV Lacquer

AVAILABLE COLORS



Ash

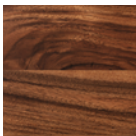

Walnut

Epoxy Tabletops

In Epoxy tabletops, nature's beauty meets modern design. These tabletops combine the aesthetics and sturdiness of natural wood with a sleek and glossy touch of resin. Each piece showcases the unique patterns and colors of the wood, creating a one-of-a-kind look. Not only are they visually striking, but they're also durable and easy to care for. The resin creates a protective layer, enhancing solid wood resistance to scratches and safeguarding it from moisture damage. Whether in your home or office, Epoxy tabletops will add a hint of elegance to your setting that is both timeless and contemporary.

THICKNESS

All options have a 1.2" thickness

SIZES & COMPATIBILITY

Available Sizes	Compatibility
60" × 30"	Solo Ryzer
72" × 30"	Solo Ryzer

COMPARISON TABLE

SKU	DT-6030	DT-7230
Grommet Style	No Grommet	No Grommet
Grommet Size	No Grommet	No Grommet
Includes	8x Machine Screws, 8x Washers, 1x Hex Key	8x Machine Screws, 8x Washers, 1x Hex Key
Dimensions (L×W×H)	60.0" × 30.0" × 1.2"	72.0" × 30.0" × 1.2"

MATERIAL

Tabletop Material	Finishing
Solid Wood with Epoxy Resin	UV Lacquer

AVAILABLE COLORS



Blue Walnut



Black Ash

Solid Wood & Epoxy Tabletops

60" x 30"

Solo Ryzer - Blue Walnut



72" x 30"

Solo Ryzer - Black Ash



72" x 30"

Solo Ryzer - Ash



60" x 30"

Solo Ryzer - Walnut



60" x 30"

Solo Ryzer - Walnut



72" x 30"

Solo Ryzer - Ash



Seamless Particle Board Tabletops

Our particle board tabletops are the perfect solution for users who prefer an L-shaped desk surface that is completely flush and leveled through a one-piece tabletop design. Measuring 59" × 59" in size, our particle board tabletop offers plenty of space for users to work with, and their rounded inner area allows for greater comfort and ergonomics when leaning on the desk.

Available in a large variety of colors, you can pick the perfect particle board tabletop style for your office! Sealed with a layer of laminate, each particle board tabletop is practically immune to humidity and other environmental factors that cause cracking, splitting, or warping. Stylish, high-quality, and durable, we back our particle board tabletops with a 15-year warranty so you can rest assured that your tabletop will serve you well!

THICKNESS

All options have a 1.00" thickness

SIZES INCLUDE

Size

59" × 59"

COMPATIBILITY

Standing Desk

Corner Ryzer

INCLUDED HARDWARE

Hardware	Qty
M6×18 Machine Screws	16
Hex Key	1

MATERIAL

Surface Material	Bottom Material	Edge Material	Core Material
Laminate	Laminate	PVC	Particle Board

AVAILABLE COLORS

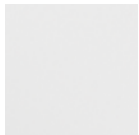

Cool
White



White
Birch

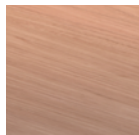

Sunset
Teak



Dark
Oak

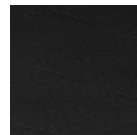

Midnight
Maple

Seamless Particle Board Tabletops

59" x 59"

Corner Ryzer - White Birch



59" x 59"

Corner Ryzer - Sunset Teak



59" x 59"

Corner Ryzer - Dark Oak



59" x 59"

Corner Ryzer - White Birch



Care & Maintenance

We recommend cleaning your tabletops with an eco-friendly cleaning product to preserve the material's structure, look, and feel.

Wipe your table regularly, irrespective of the tabletop material. Use a soft brush or feather duster to sweep away accumulated dust. If you have a portable vacuum cleaner, choose the dusting brush tool and set it to the lowest level to prevent damage while cleaning. Regular dusting maintains a clean surface without much hassle!

If you still notice dirt after initial cleaning, use a mild soap solution for MDF and bamboo tabletops. Mix two parts of water with one part of mild soap in a spray bottle. We emphasize using mild soaps as they don't have strong or acidic elements found in regular cleaners. You may also go for hand soap, which is gentle, protecting your tabletop material. Spray the mixture directly onto the table for effective cleaning. Clean with a soft sponge or cloth, avoiding excessive pressure to prevent marks and scratches. If marks persist, respray the mixture and apply extra force on tough stains. Wipe the entire tabletop again for a thorough cleaning.

After cleaning, let the table fully dry before use to prevent stains and damage from water residue. The drying time varies based on climate conditions, typically from a few minutes to an hour. Check the surface for dryness by touching it; the table is ready for use if there are no fluid particles.

Tabletop Care Don'ts:

1. Don't brush with force.
2. Don't use too much water.
3. Don't use blow dryers.

Important for all Tabletops:

- Avoid prolonged moisture exposure as it may cause watermarks – remove any liquid spills promptly.
- Avoid rain and direct sunlight exposure – tabletops are intended for indoor use only.

Important for Bamboo Tabletops:

- Ensure ventilation and occasional damp towel wiping for balanced moisture in dry and air-conditioned spaces.
- Ensure regular care and cleaning every few weeks to a month.

If your tabletop shows some wear and tear signs, please check our article on how to repair surface scratches, which also provides more tips on keeping your tabletop in perfect condition for longer.

Tabletop Dimensional Drawings

Single Tabletops

Dimensions in inches. Pre-installed threaded screw inserts and hardware included. Sizes have a 1.00 inch thickness except those available in Epoxy, which feature a slightly thicker 1.2 inches for added durability.

30" × 30"

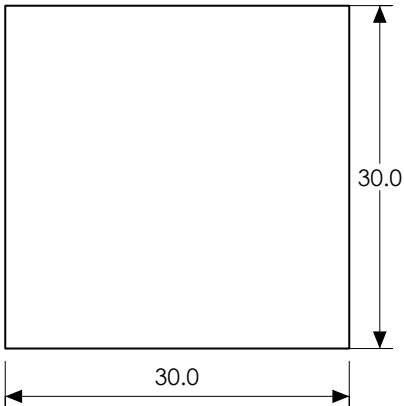

55" × 28"

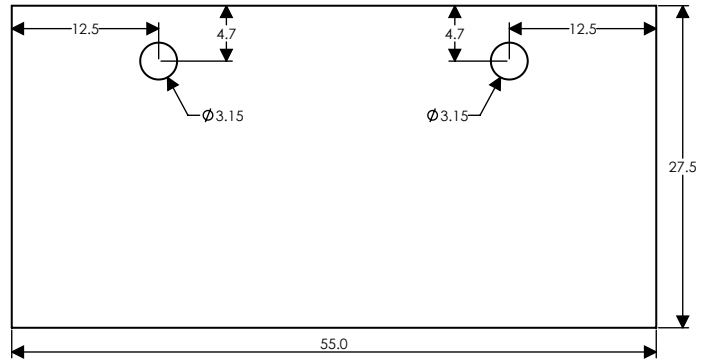

42" × 24"

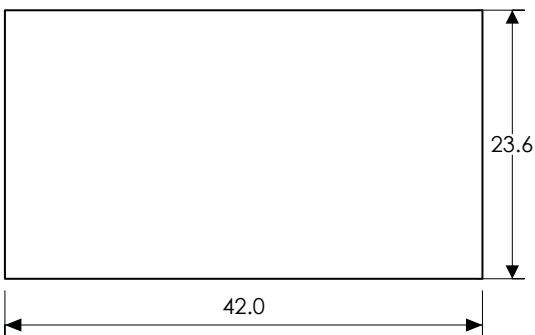

60" × 30"

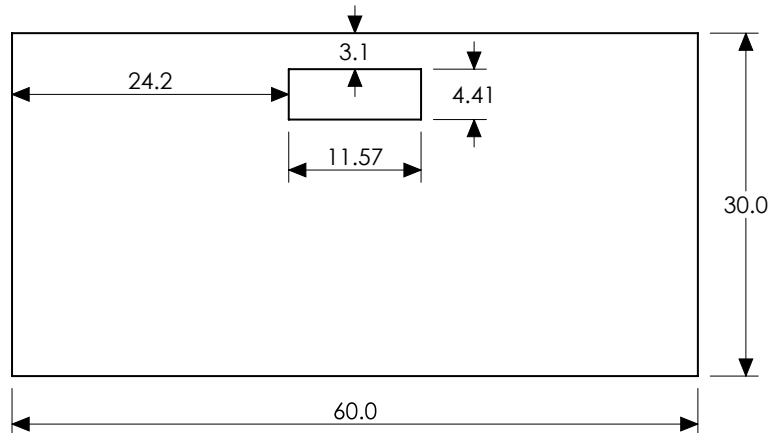

48" × 30"

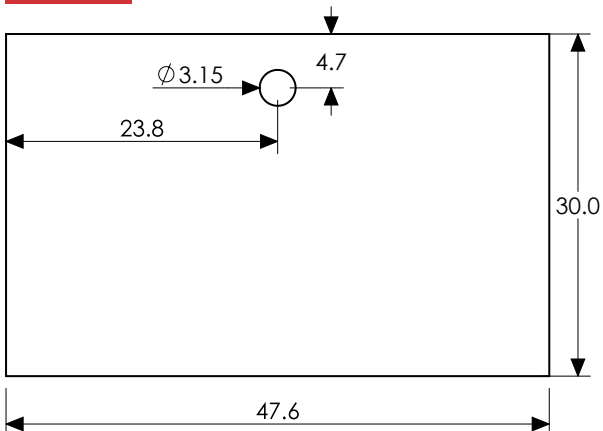

72" × 30"

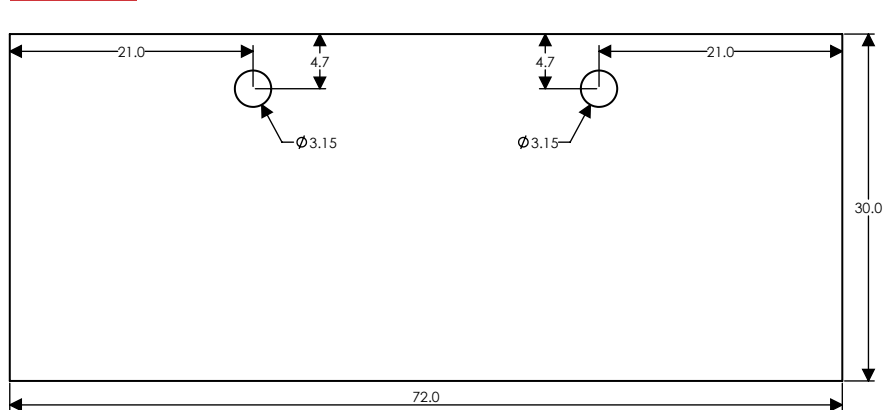

Tabletop Dimensional Drawings

Single Tabletops

Dimensions in inches. Pre-installed threaded screw inserts and hardware included. Sizes have a 1.00 inch thickness except those available in Epoxy, which feature a slightly thicker 1.2 inches for added durability.

48" × 30"

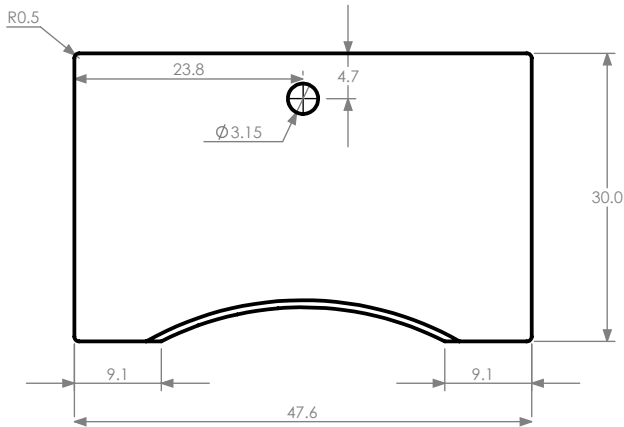

55" × 28"

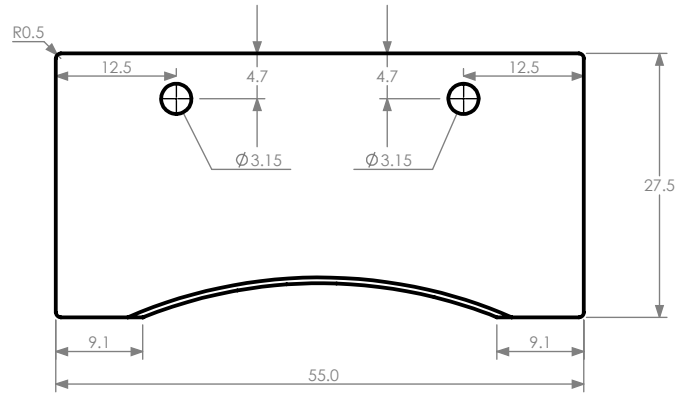

60" × 30"

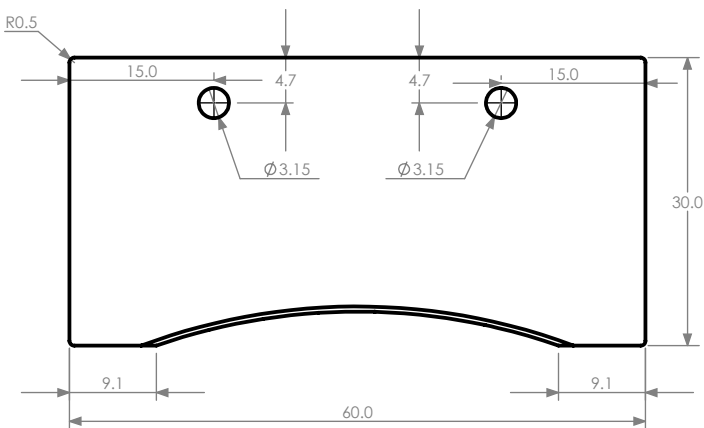

72" × 30"

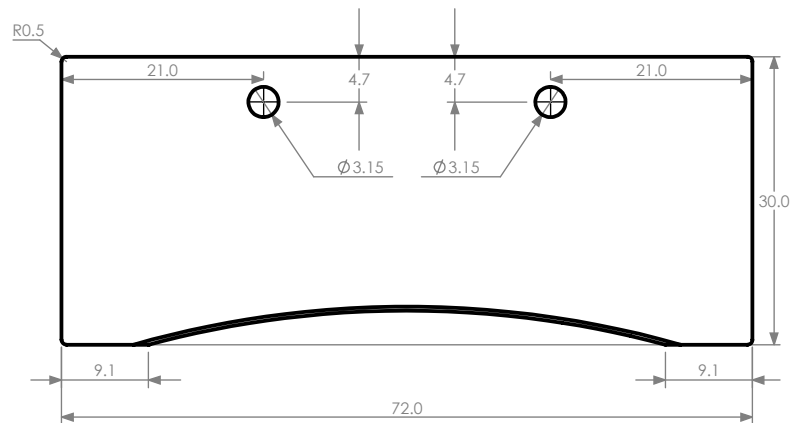

Tabletop Dimensional Drawings

L-shaped Tabletops

Dimensions in inches. Sizes have a 1.00-inch thickness. Hardware included and except for the 59"x59", all L-shaped tabletops are equipped with pre-drilled holes.

59" × 59"

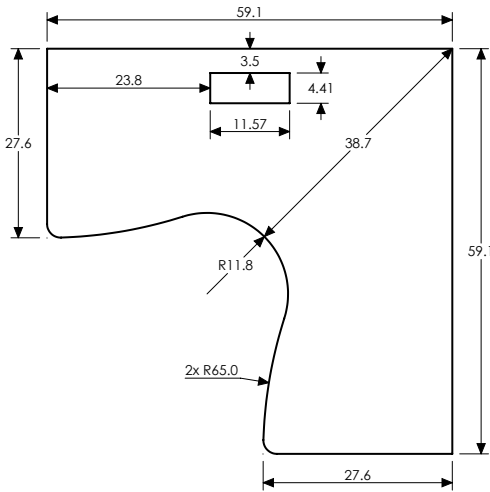

60" × 48"

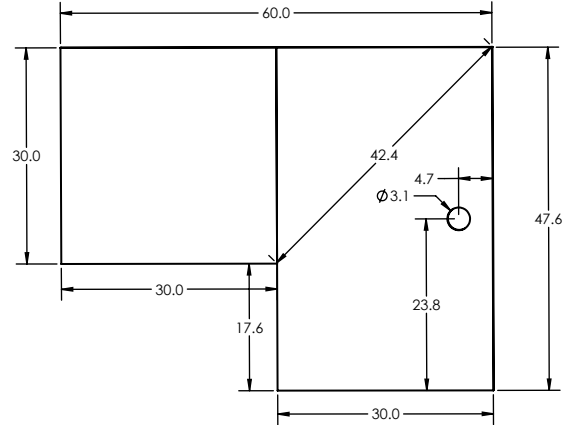

72" × 48"

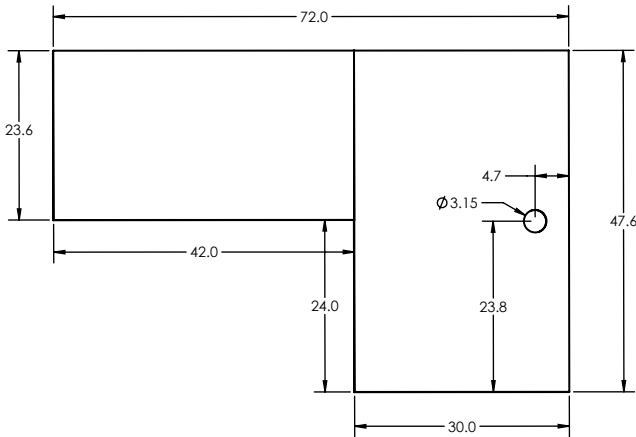

78" × 48"

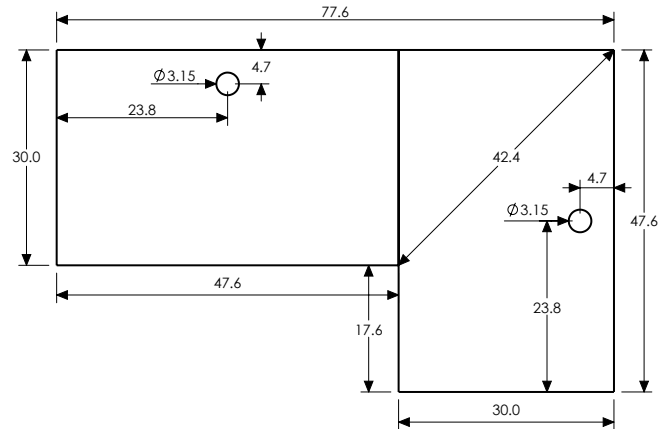

85" × 48"

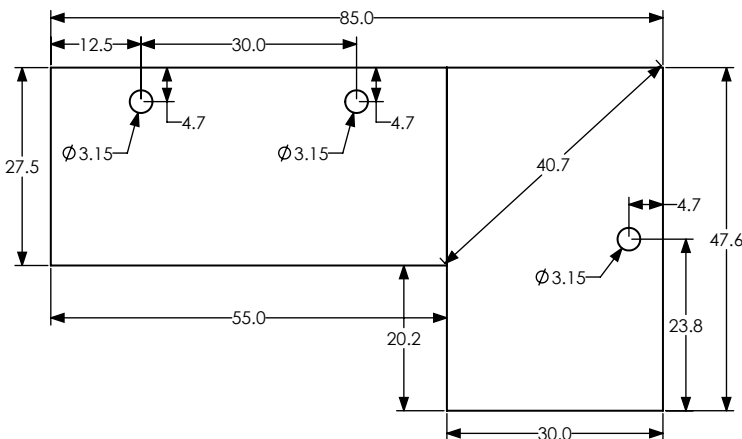

90" × 48"

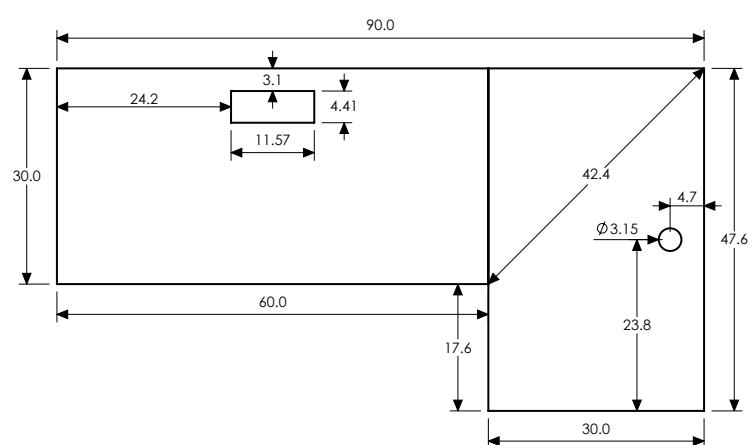

Tabletop Dimensional Drawings

L-shaped Tabletops

Dimensions in inches. Sizes have a 1.00-inch thickness. Hardware included and except for the 59"x59", all L-shaped tabletops are equipped with pre-drilled holes.

70" × 55"

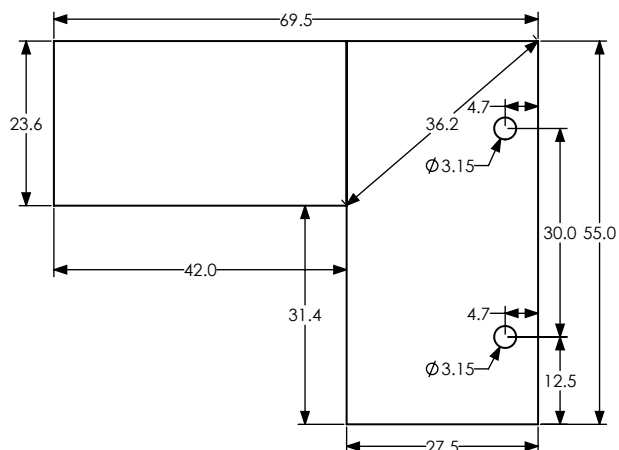

75" × 55"

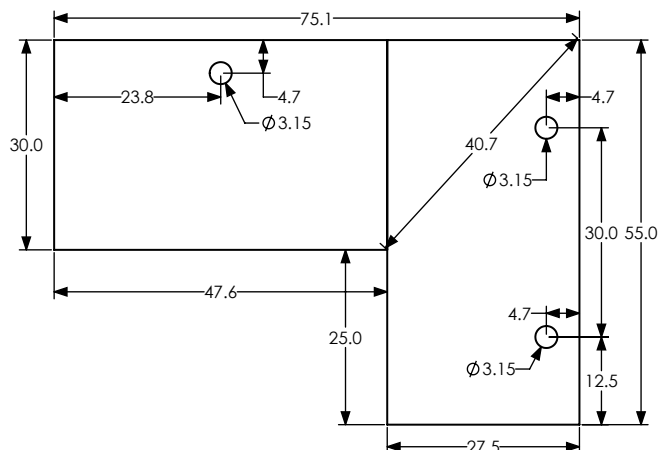

83" × 55"

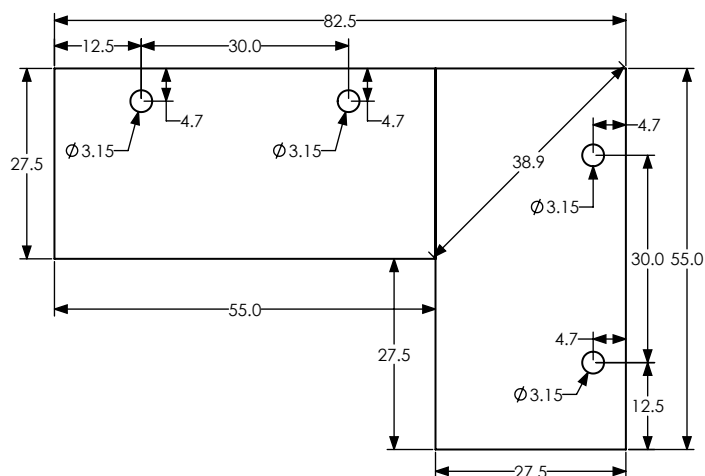

88" × 55"

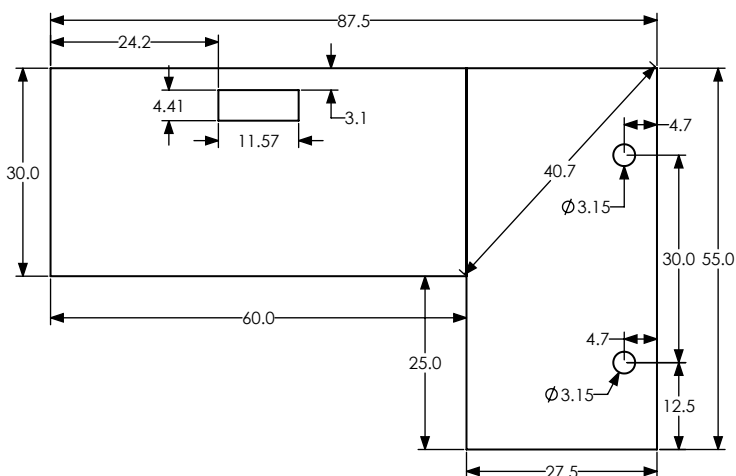

60" × 60"

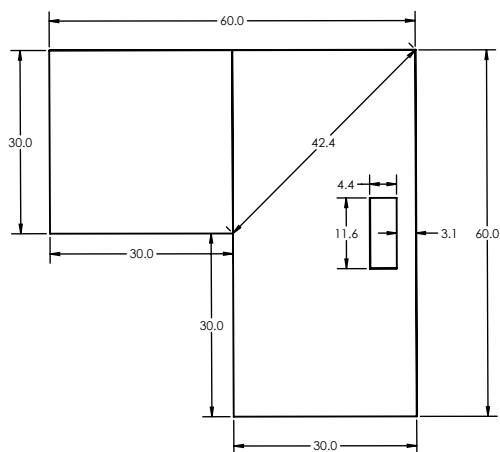

72" × 60"

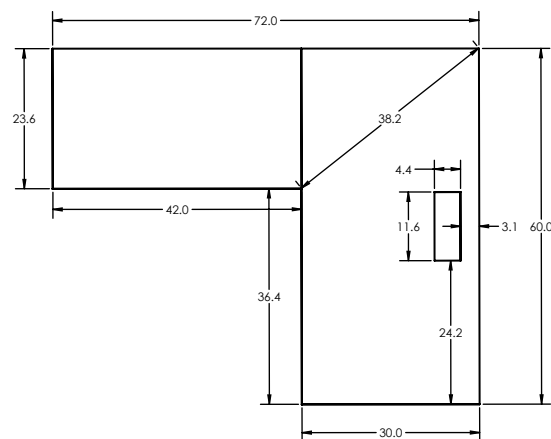

Tabletop Dimensional Drawings

L-shaped Tabletops

Dimensions in inches. Sizes have a 1.00-inch thickness. Hardware included and except for the 59"x59", all L-shaped tabletops are equipped with pre-drilled holes.

78" × 60"

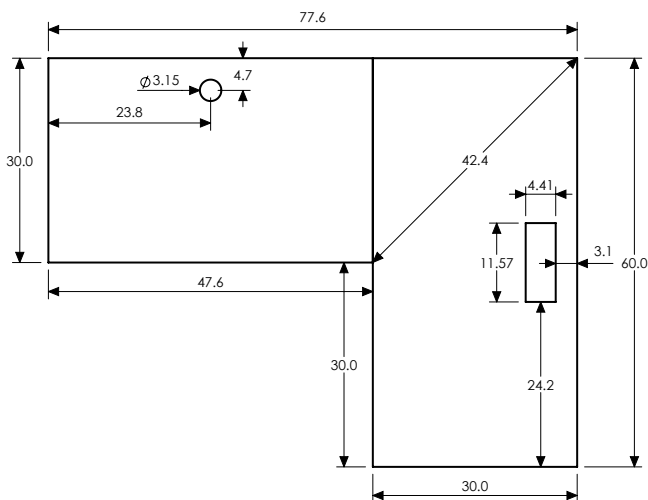

85" × 60"

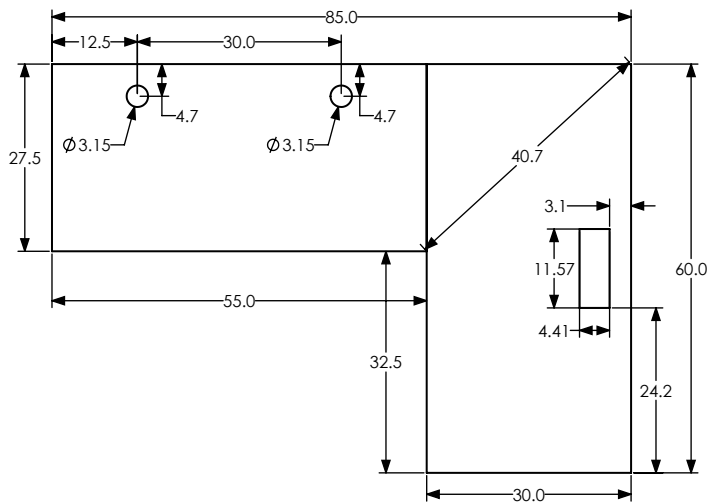

90" × 60"

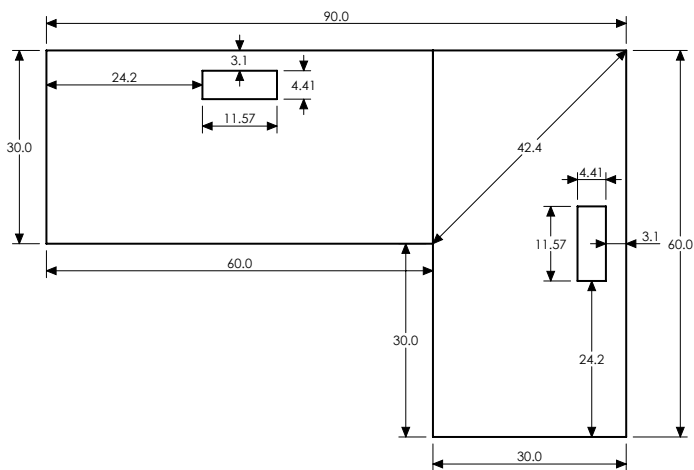

60" × 72"

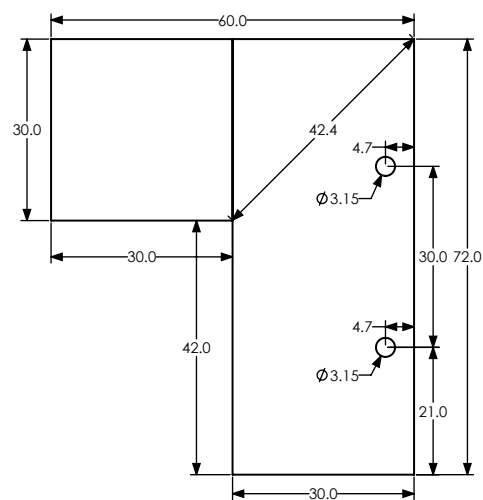

72" × 72"

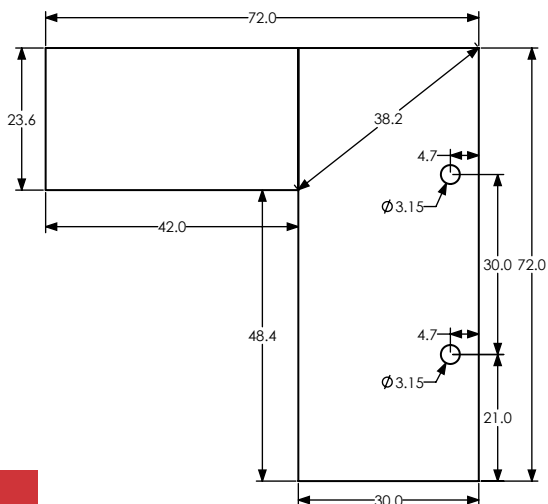

78" × 72"

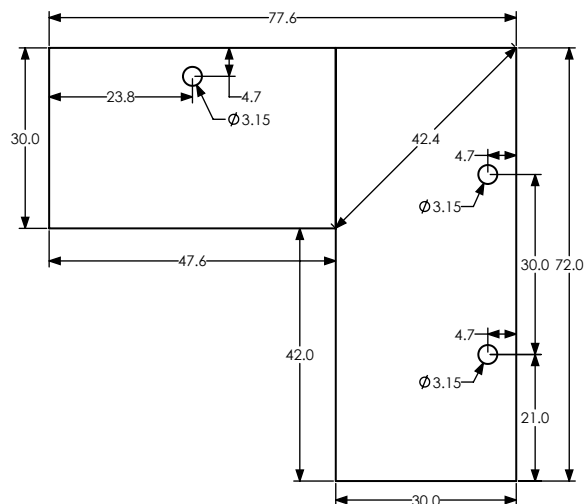

Warranty & Contact Information

We provide additional peace of mind to all of our customers with our standard 15-year warranty. This warranty applies to all of our high quality standing desks. It is extremely rare for any issues to occur with our products, but you can rest assured if something goes wrong with any part of your desk. We provide replacement products where applicable under our 15-year warranty.

What is Covered?

Under our 15-year warranty, Progressive Desk will send a replacement product to your home or office if you experience issues with the following components:

- Tabletops
- Desk Frame
- Desk Remotes

If a problem occurs, simply email us at sales@progressivedesk.com with your original order number and a brief description of the particular issue you are experiencing with the standing desk. Once our engineers assess the issue and determine that you require a replacement desk we will be happy to ship a new product immediately. We will also cover any ground shipping costs, so all you need to do is await the arrival of your replacement standing desk.

What is not Covered?

If you or your staff have made any type of modification to the desk this may make the item ineligible for replacement under the 15-year warranty. Other factors such as improper use and exposure to normal wear and tear at the workplace are also not covered by our warranty. Lastly, we are unable to cover items that have been lost or damaged due to an unavoidable accident like flooding or a hurricane.

Outside Warranty Coverage

Maintaining strong relationships with our existing customers is important to us at Progressive Desk. That is why we are pleased to offer special discounts on newer desk models to replace out of warranty items. If you're looking to update your existing standing desks, be sure to contact us and ask about our discounts.



Have any queries? Our expert engineers are here to help!



sales@progressivedesk.com



1-800-828-9414



progressivedesk.com