

VESA
100×100
75×75

17"-32"

max
5-20 lb

-90° -15°

0.79 - 2.36"

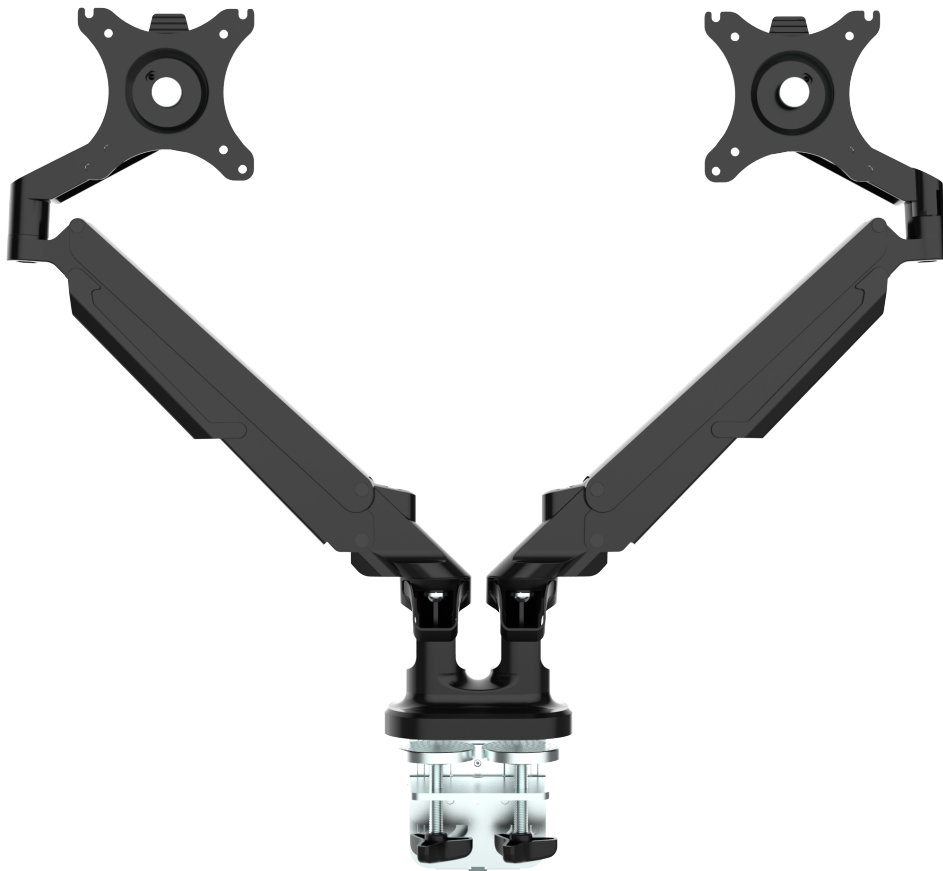

Scan for more information

DM-03-2

User Manual

Table of Contents

Specifications.....	3
Parts List.....	4
Assembly & Installation.....	5
Safety Precautions.....	8

Specifications

Monitor Compatibility	17" to 32"
Weight Capacity	5 to 20 lbs.
Product Weight	12.35 lbs.
Clamp Desk Thickness	0.79" to 2.36"
Grommet Desk Thickness	0.98" to 3.94"
Grommet Hole Compatibility	0.34" to 3.15"
VESA Compatibility	100mm x 100mm and 75mm x 75mm
Base Rotation	±120°
Arm Joint Rotation	±180°
Monitor Swivel	±90°
Monitor Rotation	±360°
Tilt	-90° to 15°
Max Height	17.91"
Clamp Mount	Included
Grommet Mount	Included
Quick Release VESA	Included

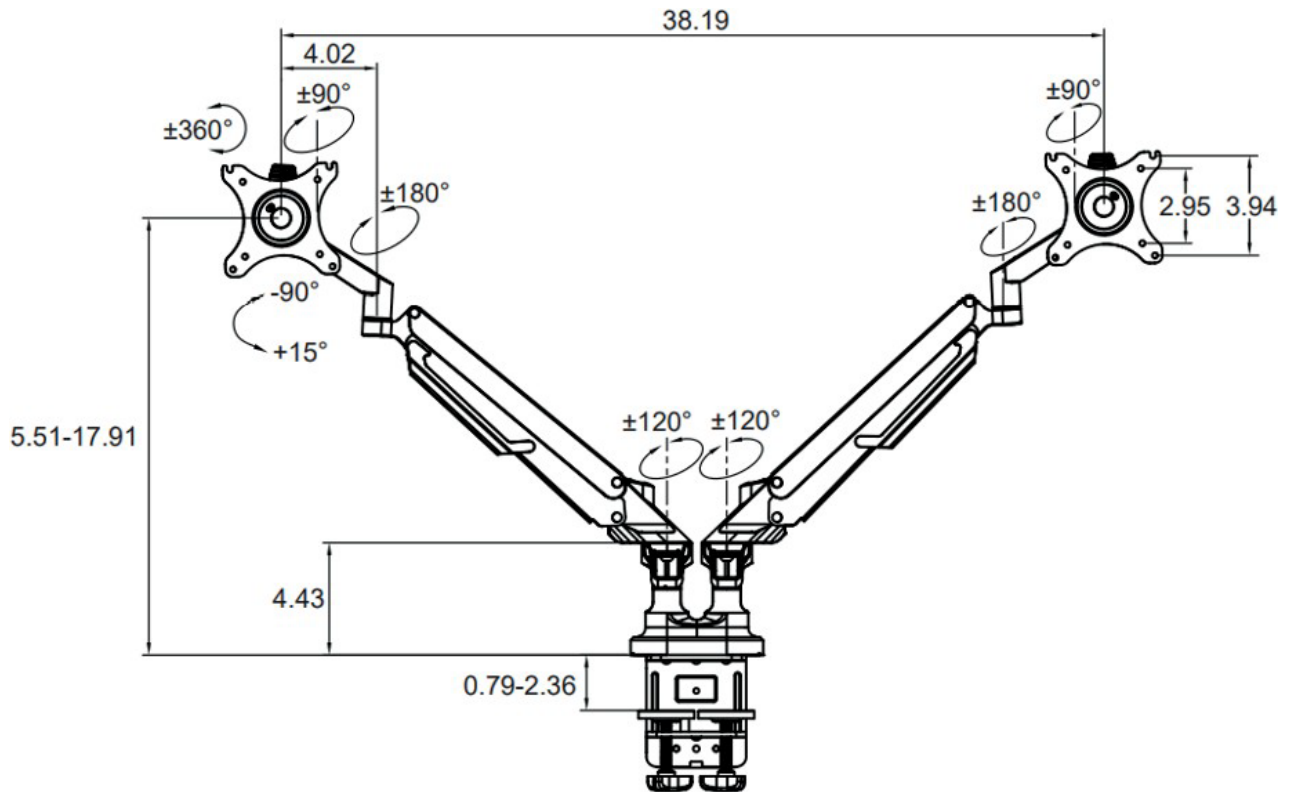

Parts List

Tools Needed:



A

M4x12mm (x8)



B

M5x12mm (x8)



C

M6x12mm (x3)



D

Washer (x16)



E

4mm Hex Key (x1)



F

5mm Hex Key (x1)

1. Monitor Arm (x1)
2. Clamp (x1)
3. Rubber Clamp Pad (x2)
4. Rubber Base Pad (x1)
5. Clamp Cover (x1)
6. Grommet Base Plate (x1)
7. Grommet Screw (x1)
8. Grommet Anti-Slip Pad (x1)
9. Grommet Bottom Plate (x1)
10. Grommet Knob (x1)
11. VESA Plate (x2)
12. Cable Clip (x2)

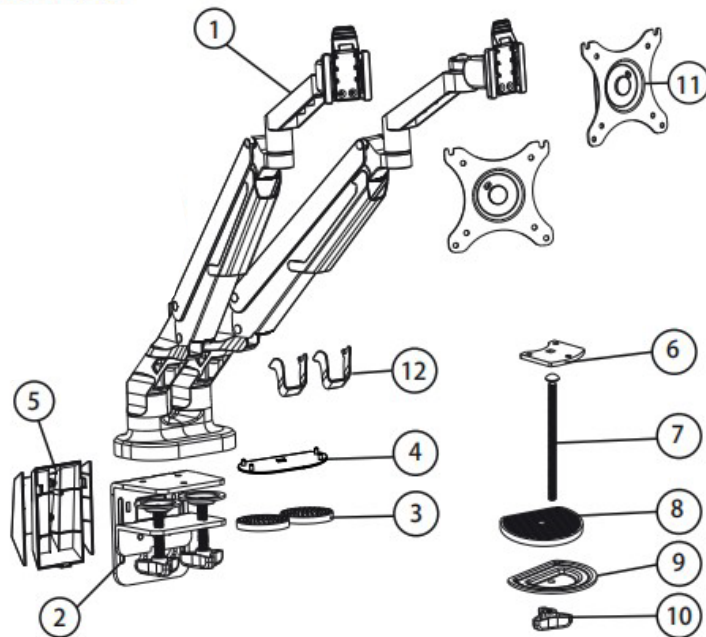

Assembly & Installation

Step 1: Choose Installation Method (Clamp or Grommet)

Option 1: Clamp – Desk Side Mount

Select the appropriate mounting slot according to the thickness of your tabletop.

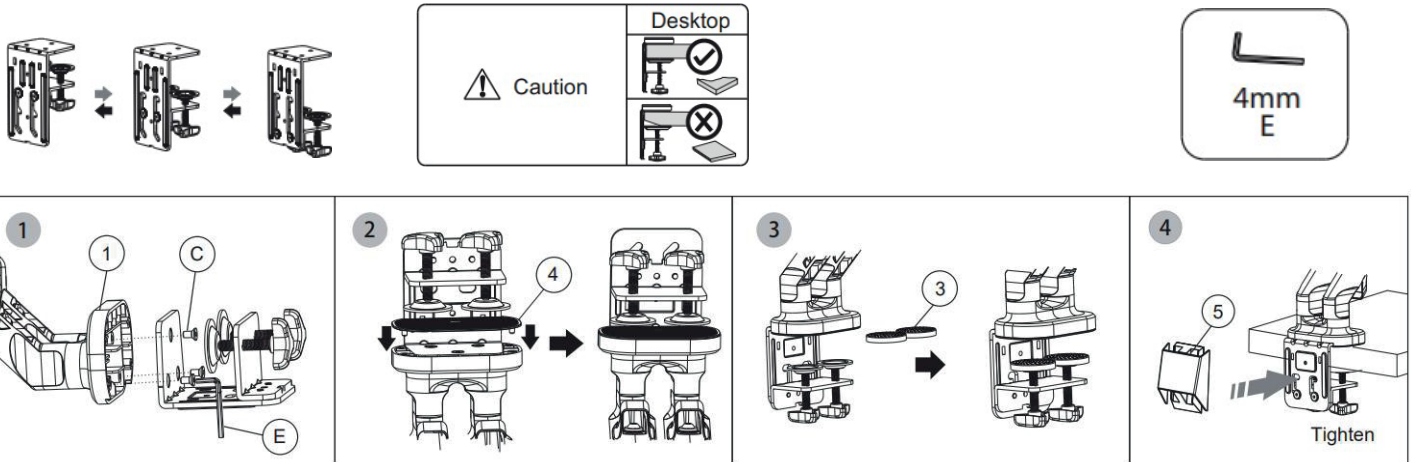

Compatible with 0.8" to 2.3" thick tabletops

Option 2: Grommet – Desk Hole Mount

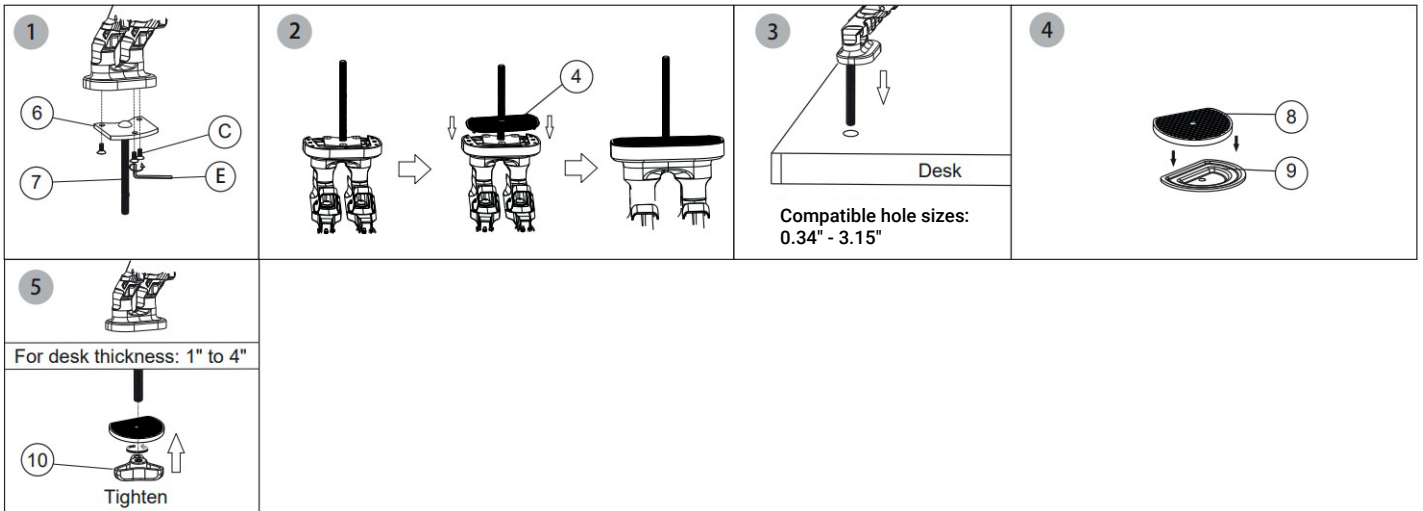

Step 2: Install VESA Plate

Connect the Quick Release VESA Plate (11) to your monitor

1. Use Washers (D) if needed. Select Screws (A or B) depending on the monitor screw requirements.

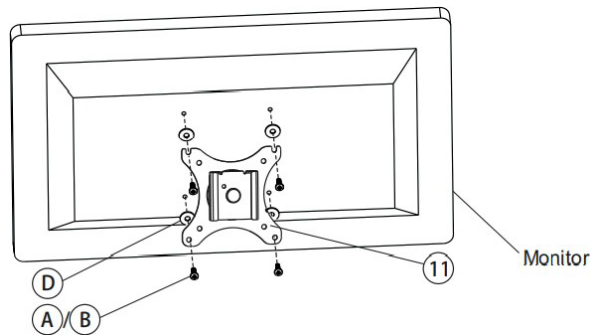

2. Use the 5mm Hex Key (F) to tighten the screws.

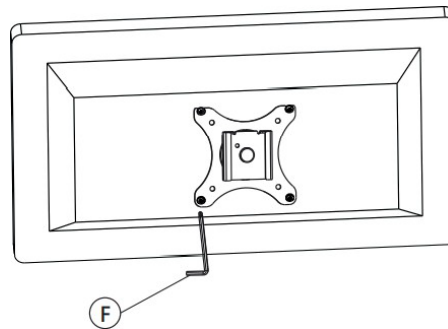

Step 3: Install Monitor Arm

Install the VESA Plate to the Monitor Arm

1. Attach the VESA plate to the arm from top to bottom.

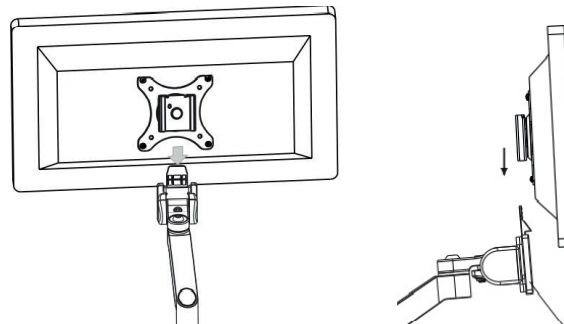

2. Ensure it is locked properly.

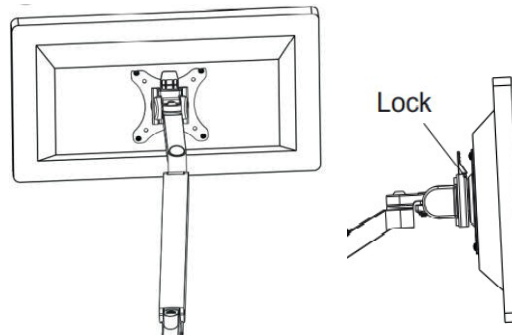

Step 4: Adjust Range of Motion

Adjust the Monitor Arm (14) for both arms

Adjust the swivel using the 5mm Hex Key (F) at position 1. Adjust the tilt by using the 5mm Hex Key (F) at position 2.

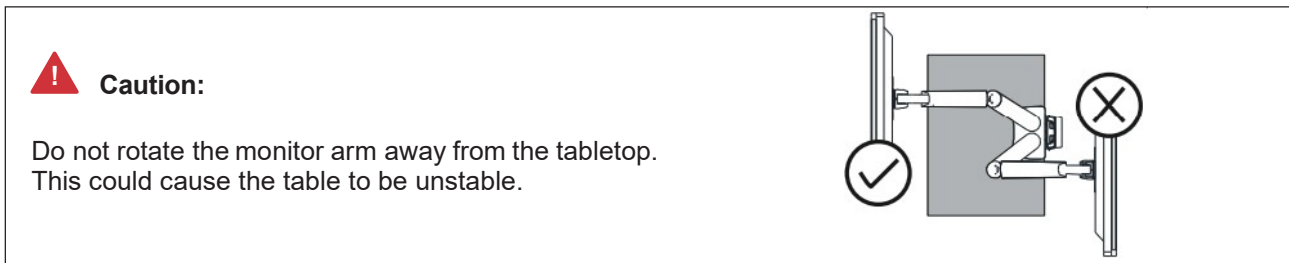
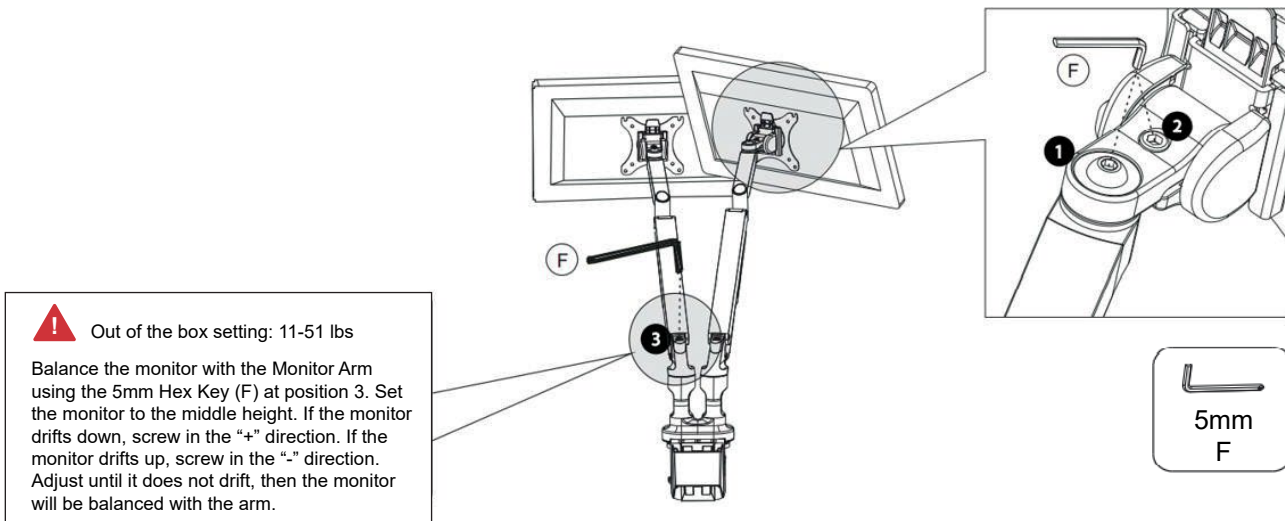

Step 5: Rotate the Monitor Arm

For small monitors, rotate the upper arm to close the gap between the two monitors.

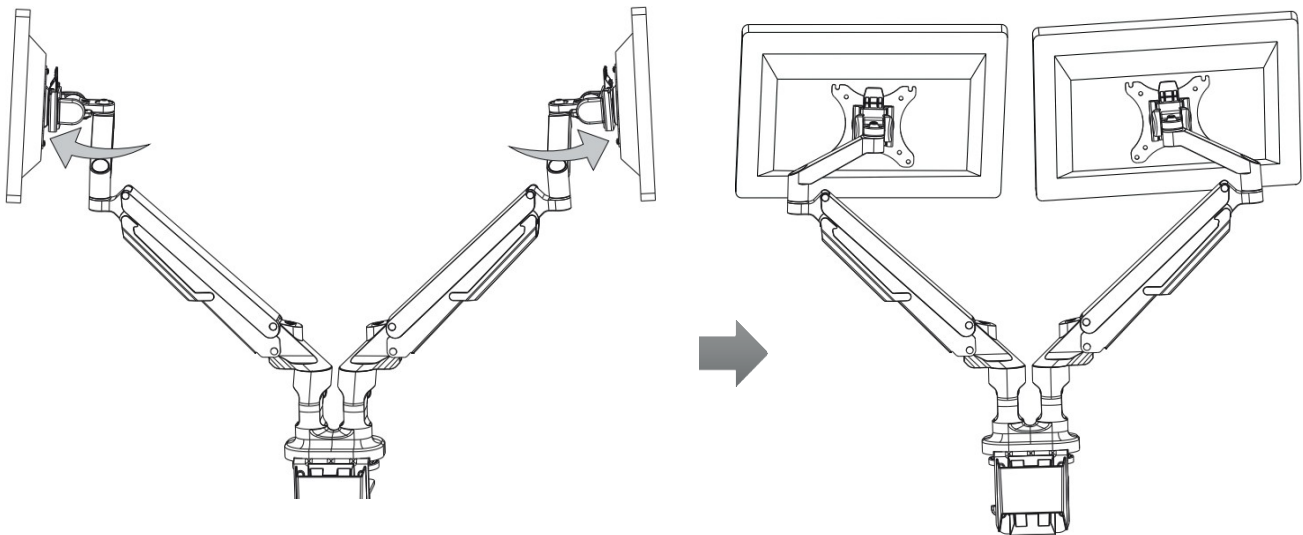

Step 6: Cable Management

1. Adjust the swivel using the 5mm Hex Key (F) at position 1. Adjust the tilt by using the 5mm Hex Key (F) at position 2.
2. Attach the Cable Clips (12) after organizing the cables with adequate slack for the full range of motion of the Monitor Arm.

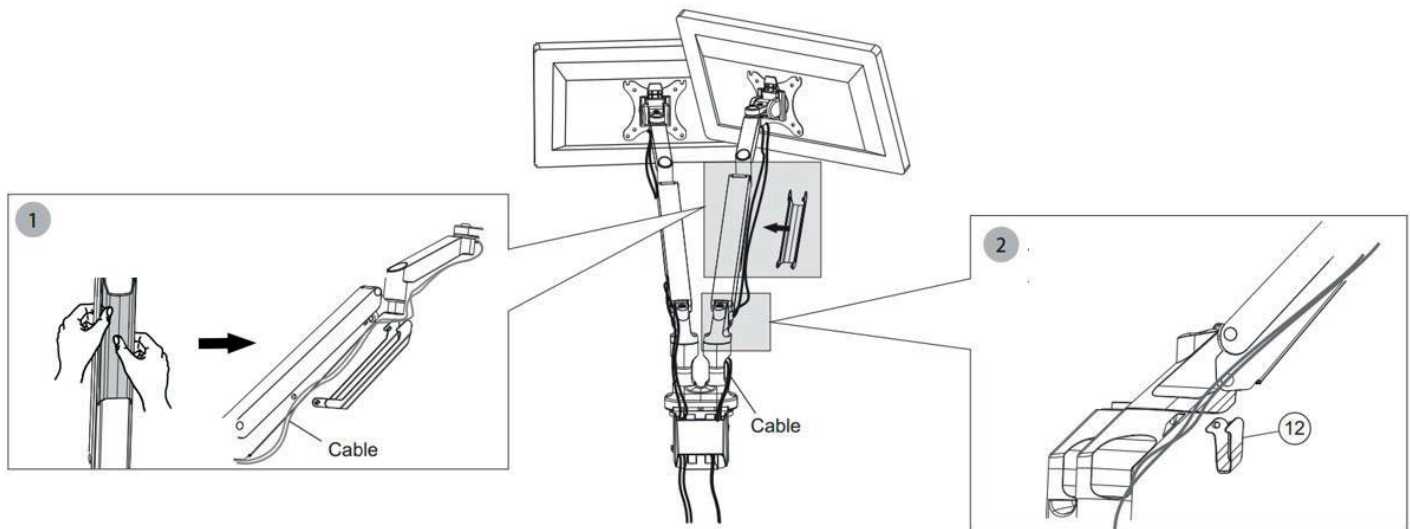

Safety Precautions

- This product contains small items that could be a choking hazard if swallowed. Keep these items away from young children. Please ensure all instructions are read and completely understood before attempting installation. If you are unsure of any part of this installation, please contact a professional installer for assistance.
 - The desk or mounting surface must be capable of supporting the combined weight of the Monitor Stand and monitors, otherwise the structure must be reinforced. To ensure optimal performance, check for any loose screws every two months.
 - This product was designed to be installed onto a tabletop. Before installing, make sure the mount will support the combined load of the mount and display. Never exceed the maximum load capacity of 20 lbs. per arm or this may result in product failure or personal injury.
 - This product is intended for indoor use only. Use of this product outdoors could lead to product failure or personal injury.
- ⚠ WARNING** – This product contains high pressure gas spring parts, please do not put it into fire, high temperatures, or disassemble it, which will lead to unexpected personal injury. Defective products can be sent back to the manufacturer or handed over to professional institutions. To ensure the sealing performance of the gas spring, we recommend that the arm is moved through its full range of motion at least once a month to maintain its long term functionality.



Have any queries? Our expert engineers are here to help!



sales@progressivedesk.com



1-800-828-9414



progressivedesk.com