



Scan for more information

ST-03

User Manual

Table of Contents

Specifications	3
Parts List	4
Assembly & Installation	5
Adjustability	9



Have any queries? Our expert engineers are here to help!



sales@progressivedesk.com



1-800-828-9414



progressivedesk.com

Specifications

Headrest Removable	Yes
Headrest Height Range	2.4"
Headrest Tilt Adjust	Included
Backrest Locking	3 Positions
Backrest Tension Control	Included
Recline Angle	95° - 130°
Lumbar Height	Adjustable
Lumbar Depth	Adjustable
Seat Height Range	17.7" - 21.7"
Seat Width	20.5"
Seat Depth	20.5"
Armrest Height Range	2.76"
Product Weight	36.3 lbs.
Max Weight Capacity	275 lbs.
Chair Dimensions	26.8" × 28.3" × 44.9" - 48.8"
Caster Material	Nylon
Base Material	Steel

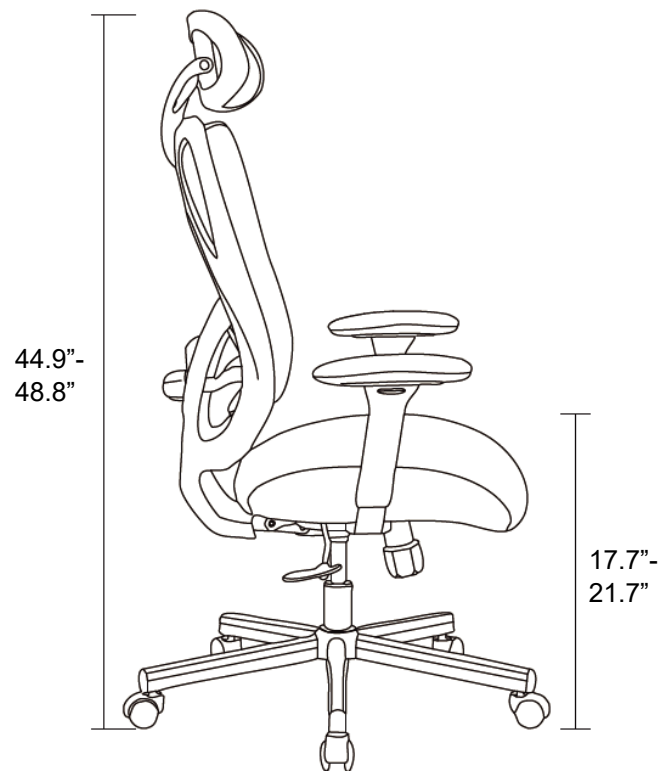
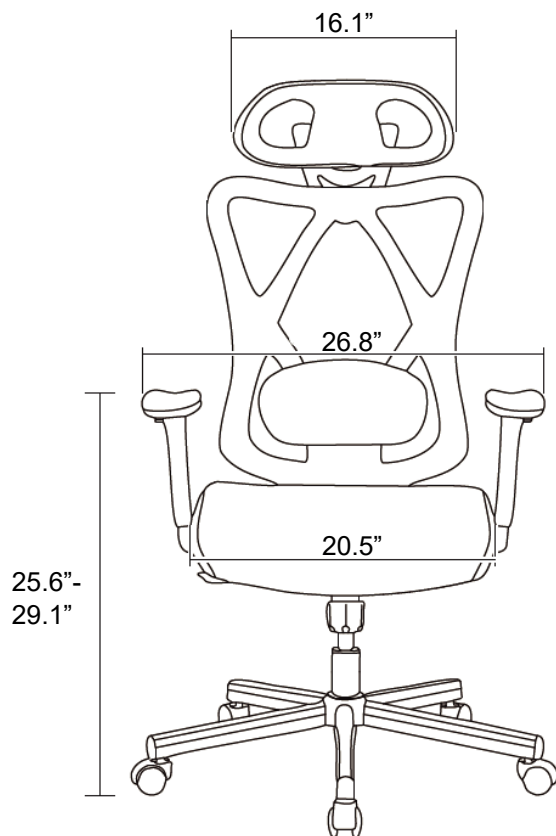

Parts List

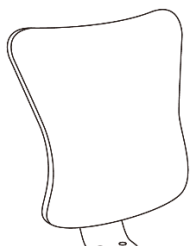

A (x1)
Back

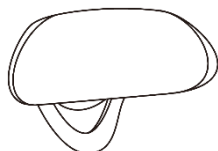

B (x1)
Headrest

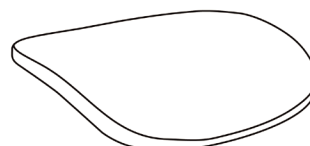

C (x1)
Seat

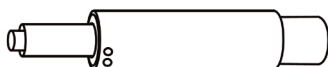

D (x1)
Gas Lift Cylinder

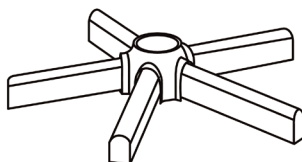

E (x1)
Base

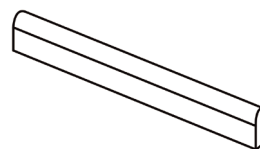

F (x5)
Base Legs



G (x6)
M6x30 Screws



G1 (X5)
5/16x20 Screws



G2 (X1)
M6x20 Screw



G3 (X5)
M6x15 Screws



G4 (X2)
5/16x25 Screws

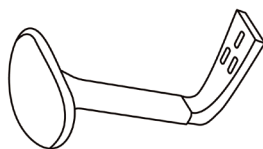

H (x1)
Right Armrest

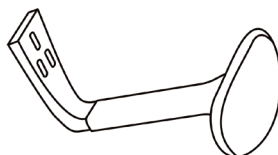

I (x1)
Left Armrest

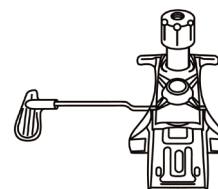

J (x1)
Tilt Mechanism



K (x5)
Casters

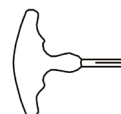

L (x1)
Allen Wrench

Assembly & Installation

Step 1: Assemble the Base

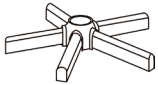

E (x1)
Base

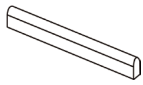

F (x5)
Base Legs



G3 (x5)
M6x15
Screws



L (x1)
Allen
Wrench

Step 1A: Remove the Base Cap from the Base (E).

Step 1B: Attach the Base Legs (F) to the Base (E).

Step 1C: Secure the Base Legs (F) using the M6x15 Screws (G3). Tighten with the Allen Wrench (L). Repeat for all 5 legs.

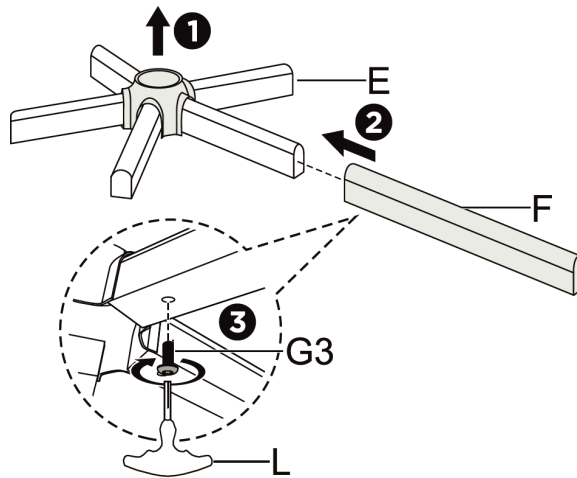

Step 2: Attach the Casters to the Base



K (x5)
Casters

Firmly insert the 5x Casters (K) into the bottom of the Base Legs (F).

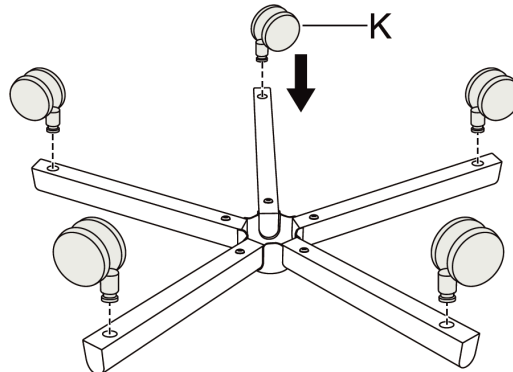

Step 3: Insert the Gas Lift Cylinder into the Base

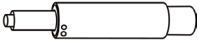

D (x1)
Gas Lift
Cylinder

Place the Base Cap back onto on the Base (E) and insert the Gas Lift Cylinder (D) with the rod side up.

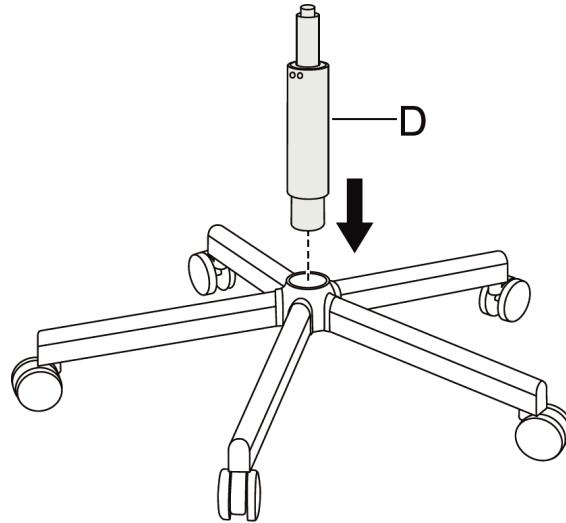

Step 4: Attach the Armrests to the Seat



C (x1)
Seat



G (x6)
M6x30
Screws



H (x1)
Right Armrest

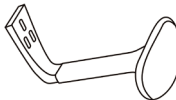

I (x1)
Left Armrest



L (x1)
Allen
Wrench

Align the armrests to the Seat (C) at the desired width. Screw in the Right Armrest (H) and Left Armrest (I) to the Seat (C) using 6x M6x30 Screws (G). Tighten with the Allen Wrench (L).

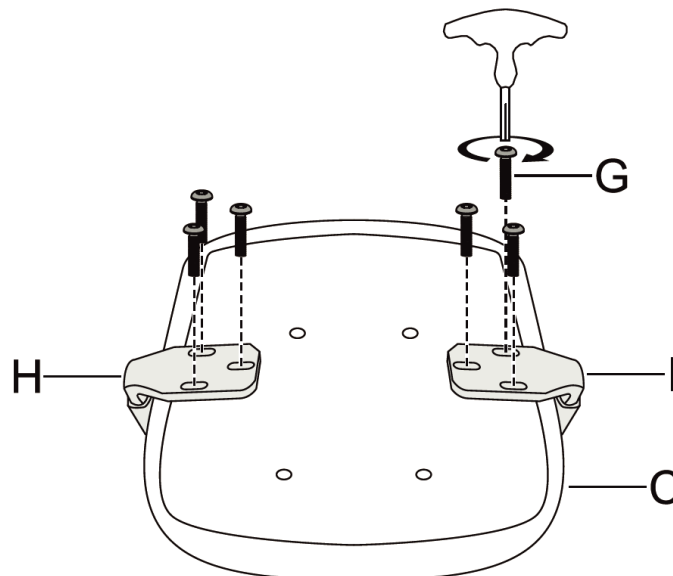

Step 5: Attach the Tilt Mechanism to the Seat

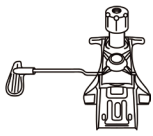

E (x1)
Tilt
Mechanism



G1 (x2)
5/16x20
Screws



G4 (x2)
5/16x25
Screws



L (x1)
Allen
Wrench

Attach the Tilt Mechanism (J) to the Seat (C) using 2x 5/16x20 Screws (G1) and 2x 5/16x25 Screws (G4). Tighten with the Allen Wrench (L).

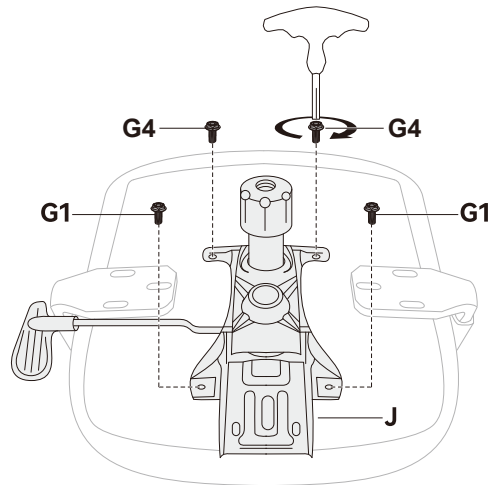

Step 6: Attach the Back to the Tilt Mechanism



A (x1)
Back



G1 (x3)
5/16x20
Screws



L (x1)
Allen
Wrench

Attach the Back (A) to the Tilt Mechanism (J) using 3x 5/16x20 Screws (G1). Tighten with the Allen Wrench (L).

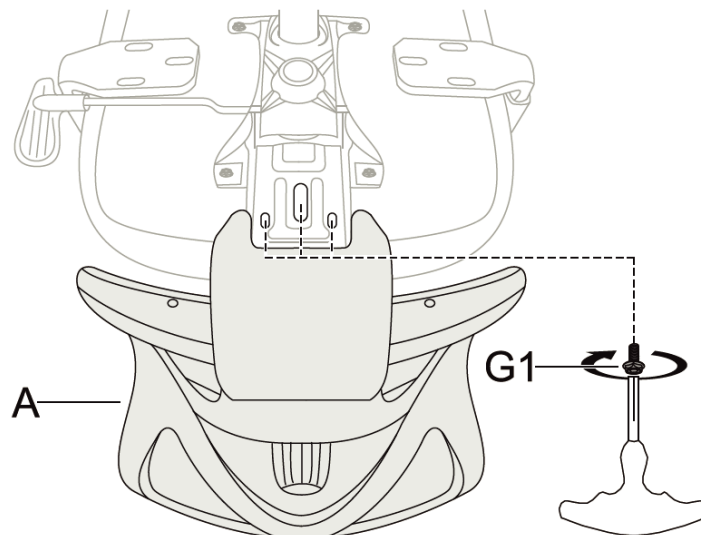

Step 7: Attach the Tilt Mechanism to the Gas Lift Cylinder

Line up the hole on the Tilt Mechanism to the Gas Lift Cylinder and attach the two parts together. Ensure that it is properly attached by applying weight on the Seat.

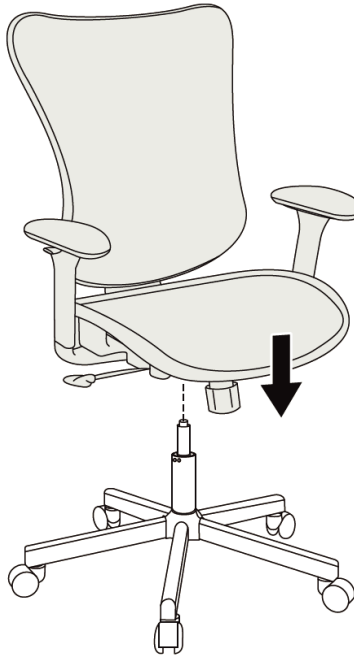

Step 8: Attach the Headrest to the Back



B (x1)
Headrest



G2 (x1)
M6x20
Screw



L (x1)
Allen
Wrench

Attach the Headrest (B) to the Back (A) using 1x M6x20 Screw (G2). Tighten with Allen Wrench (L).

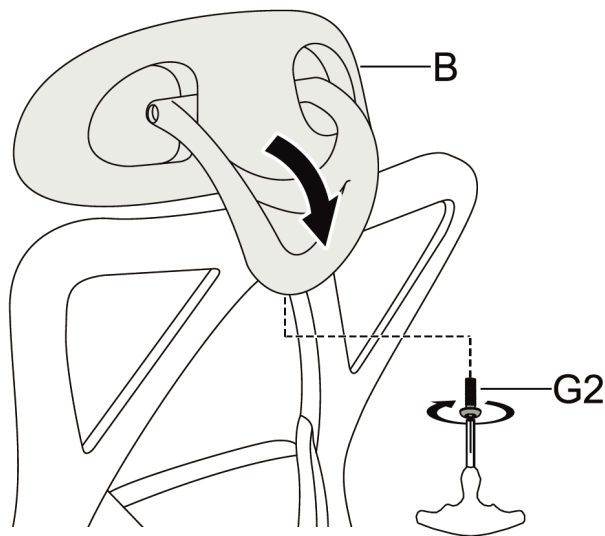

Adjustability

Seat Height

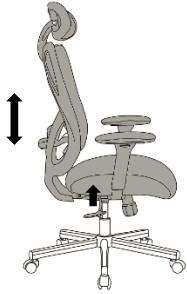

Raise the seat height by pulling the lever up. Lower the seat height by sitting in the chair and pulling the lever up,

Headrest

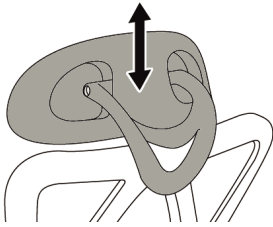

Adjust the headrest height and tilt angle to a comfortable position by applying pressure to the desired location.

Lumbar

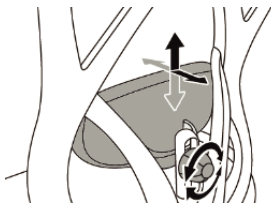

Position the lumbar support for optimal support by adjusting it up or down.

Back Tilt Locking



Lock the back at 3 different positions by leaning to the desired location and pushing the lever in. Unlock the backrest by pulling out the lever.

Backrest Tension

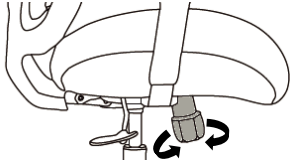

Adjust the tension in the backrest by spinning the knob underneath the seat. Turn right to increase tension and turn left to decrease tension.

Armrest Height

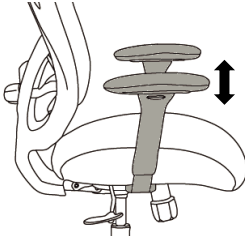

Adjust the armrest height up or down by pulling up on the lever on the outside of the armrest.



Have any queries? Our expert engineers are here to help!



sales@progressivedesk.com



1-800-828-9414



progressivedesk.com